

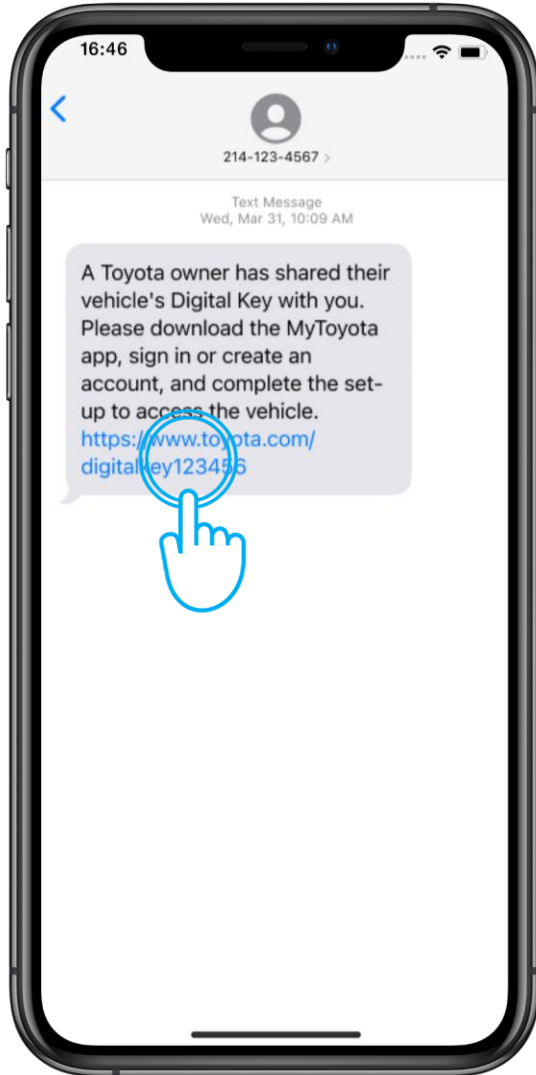

Sharing Digital Key With Friends & Family



SETTING UP YOUR ACCOUNT



STEP 1

Having been invited to share a Digital Key, you will receive a text message.

If you haven't installed the MyToyota App yet, click the link to download it.

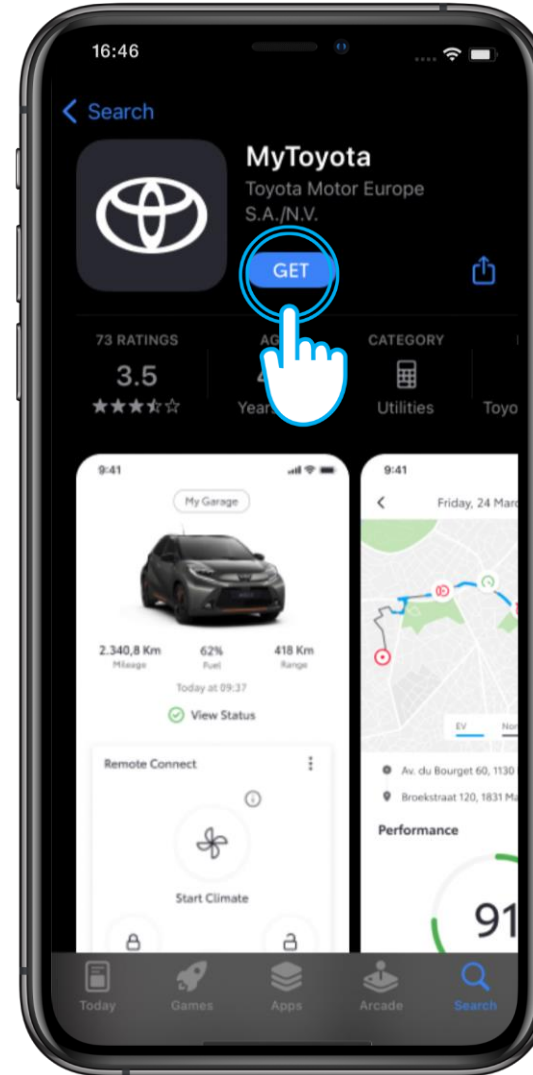

STEP 2

Download the app.



SETTING UP YOUR ACCOUNT



STEP 3

To setup your account, select "Vehicle".

Tap "Add".

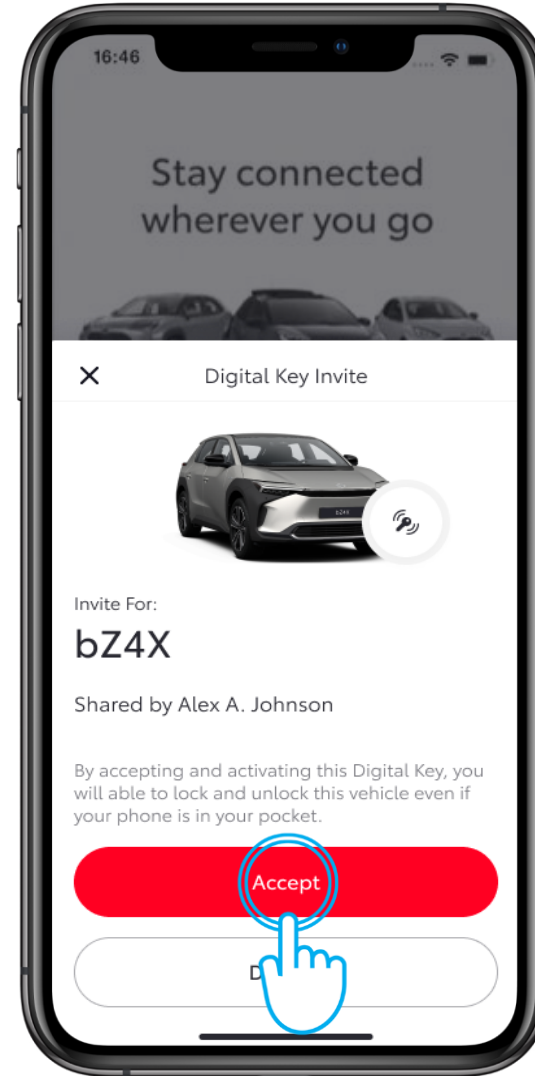

STEP 4

To proceed in downloading a shared Digital Key, tap "Accept".



SETTING UP YOUR DIGITAL KEY

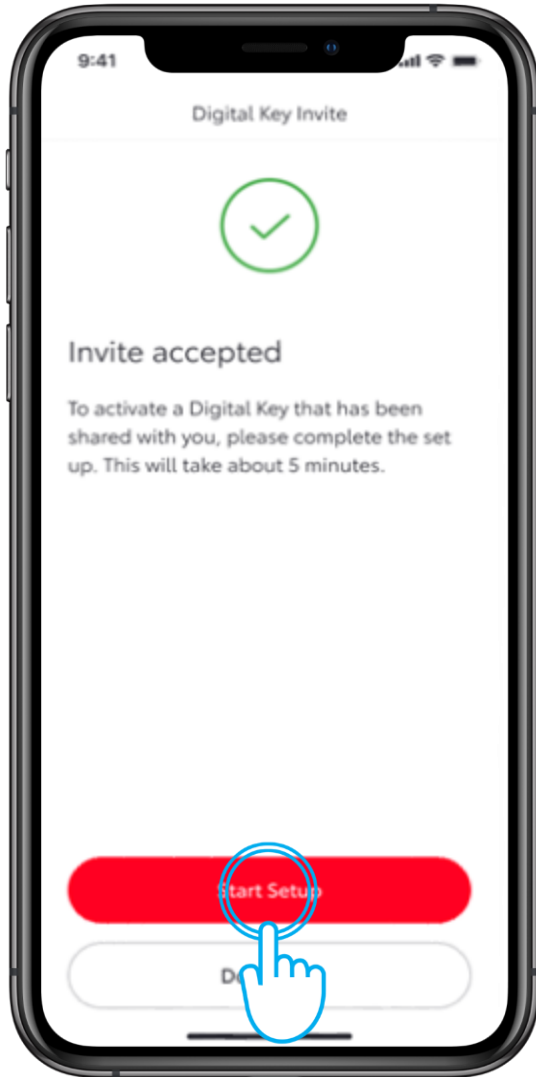

STEP 1

To activate Digital Key, tap “Start Setup”.

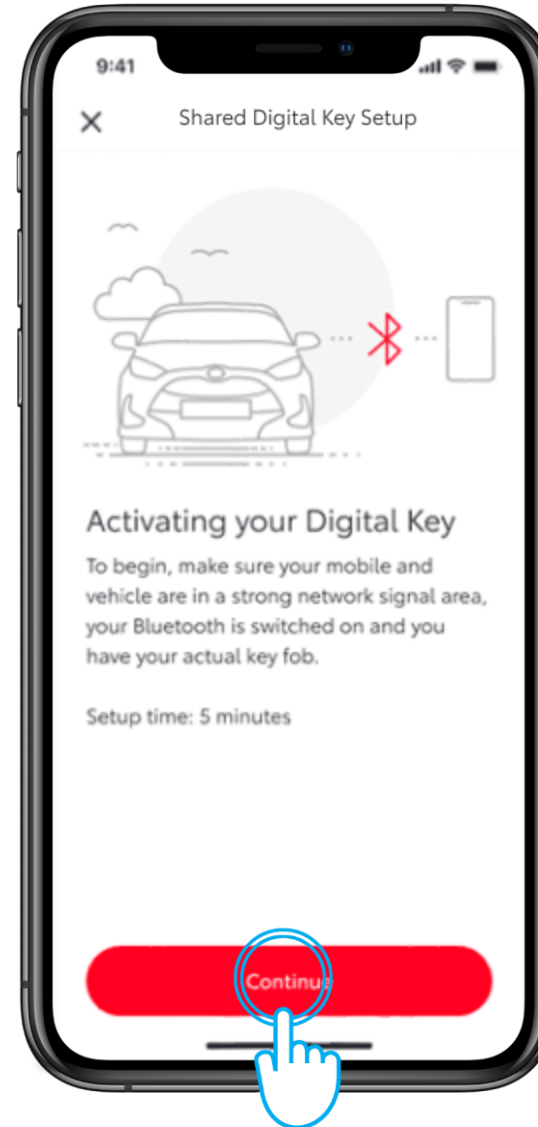

STEP 2

The setup process will begin.
Tap “Continue”.



SETTING UP YOUR DIGITAL KEY

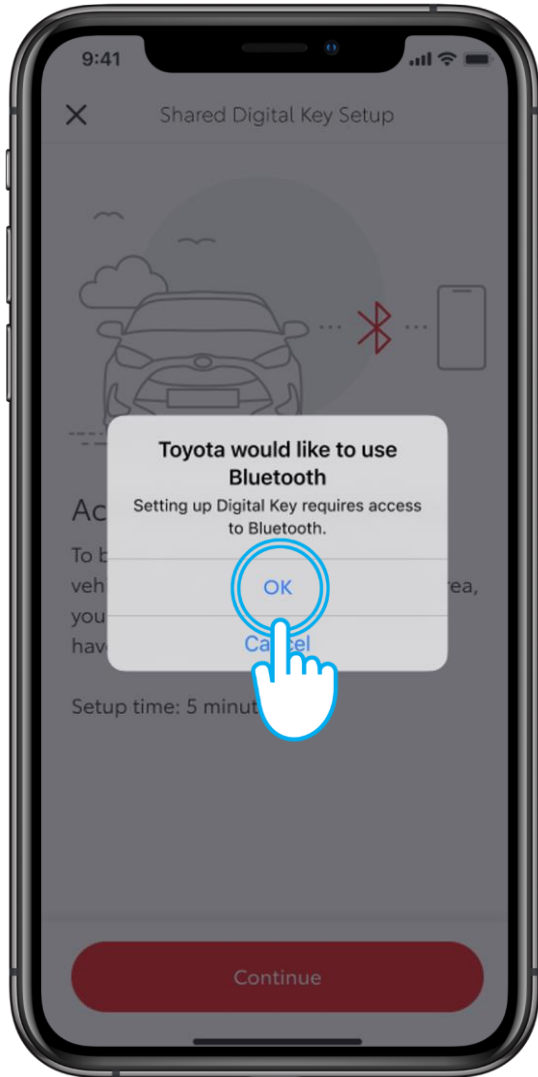

STEP 3

Bluetooth access is required to setup Digital Key.

Tap "OK".

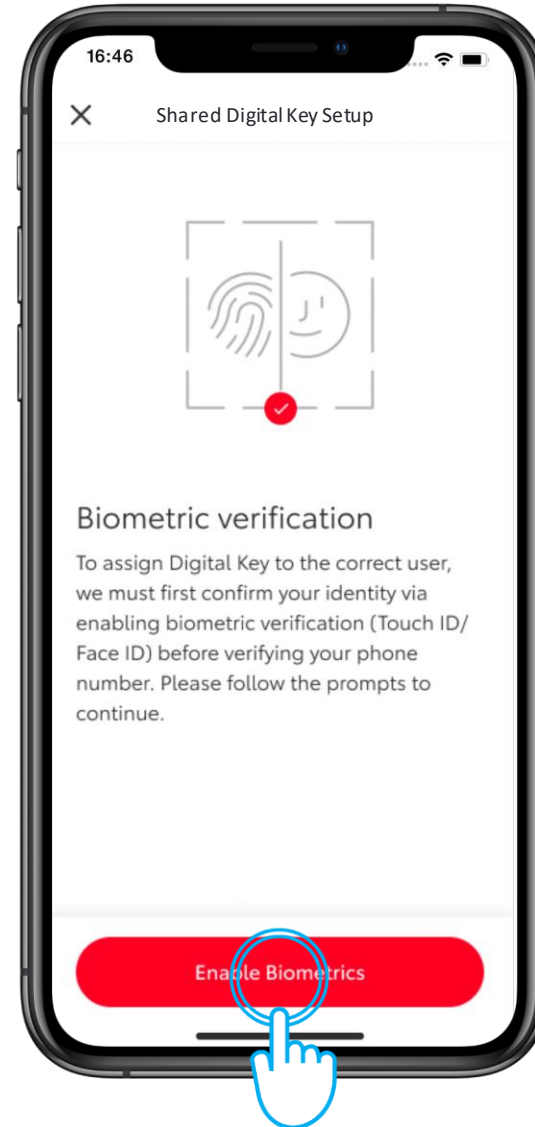

STEP 4

The app uses biometric verification to confirm your identity.

Tap "Enable Biometrics".



SETTING UP YOUR DIGITAL KEY

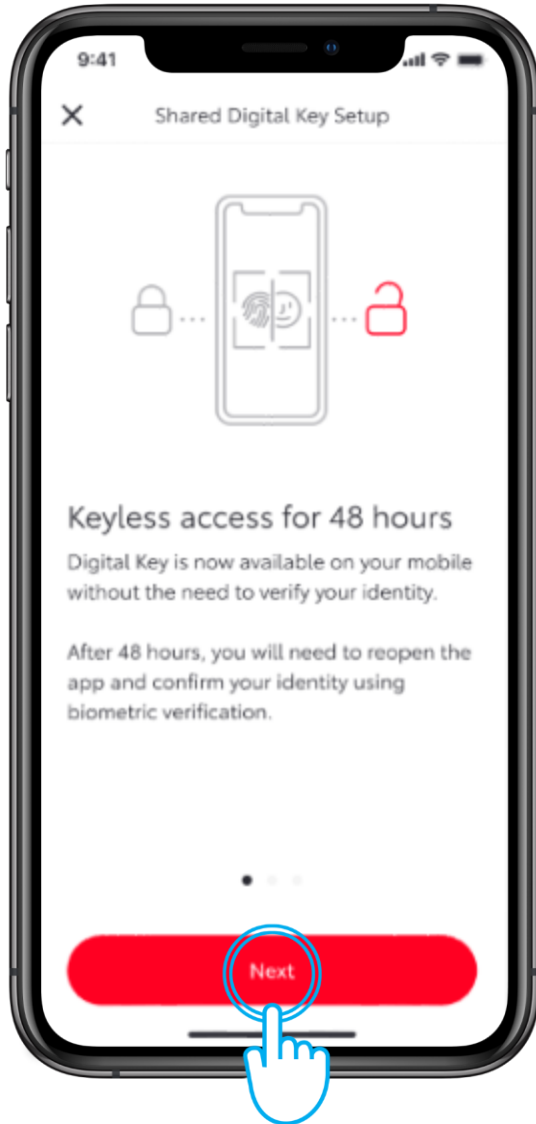

STEP 5

For 48 hours, you can now gain keyless access without the need for verifying your identity.

Tap "Next" to verify.

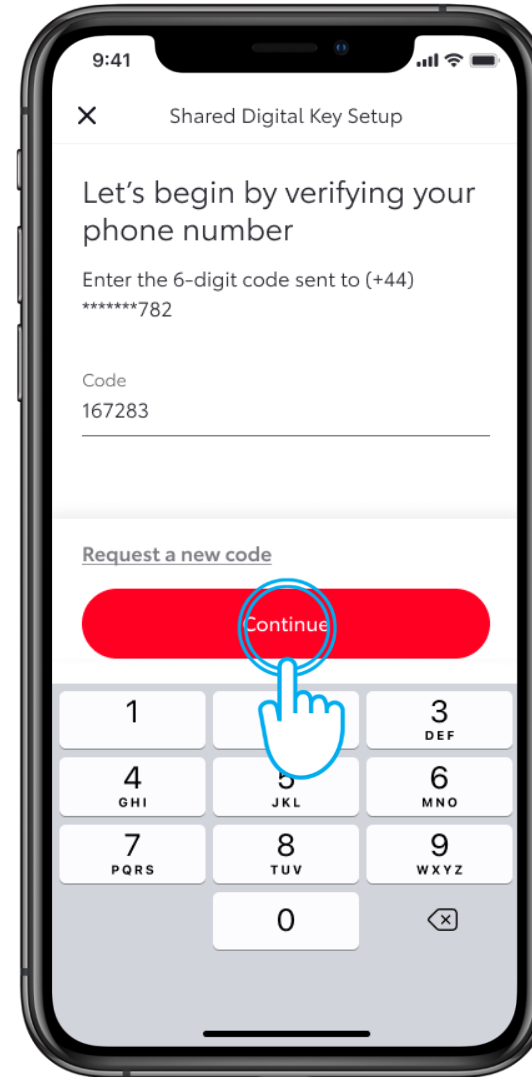

STEP 6

A 6-digit code will be sent to the phone number associated with your app account.

Enter the code and tap "Continue".



SETTING UP YOUR DIGITAL KEY

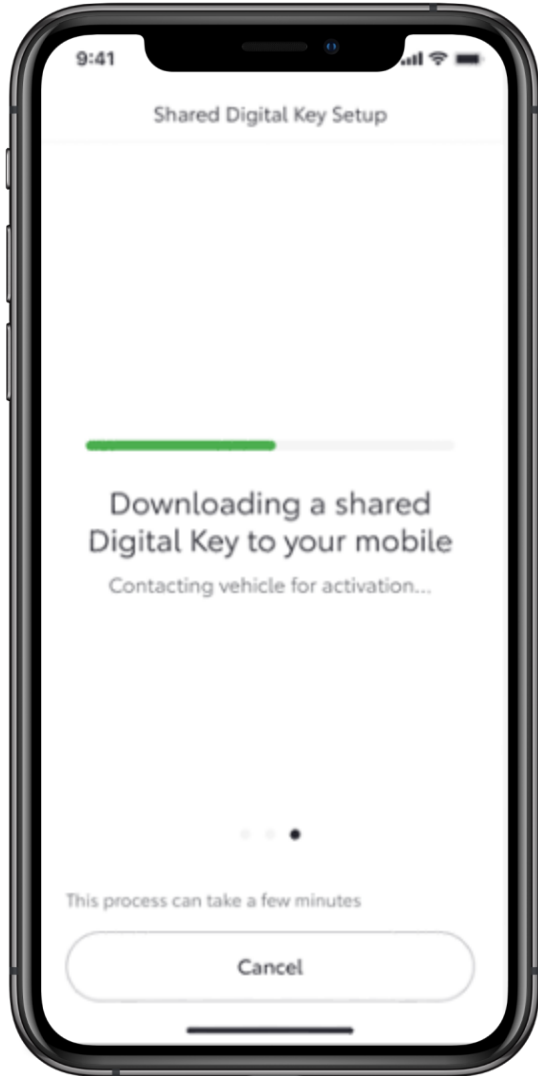

STEP 7

Digital Key will download automatically.

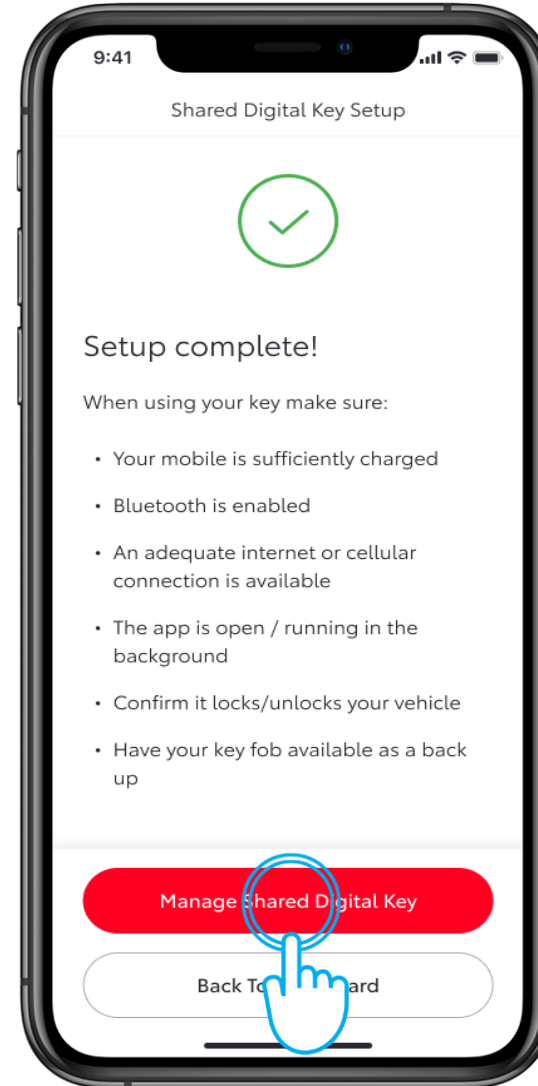

STEP 8

The app will confirm when the set up has finished.



USING YOUR DIGITAL KEY

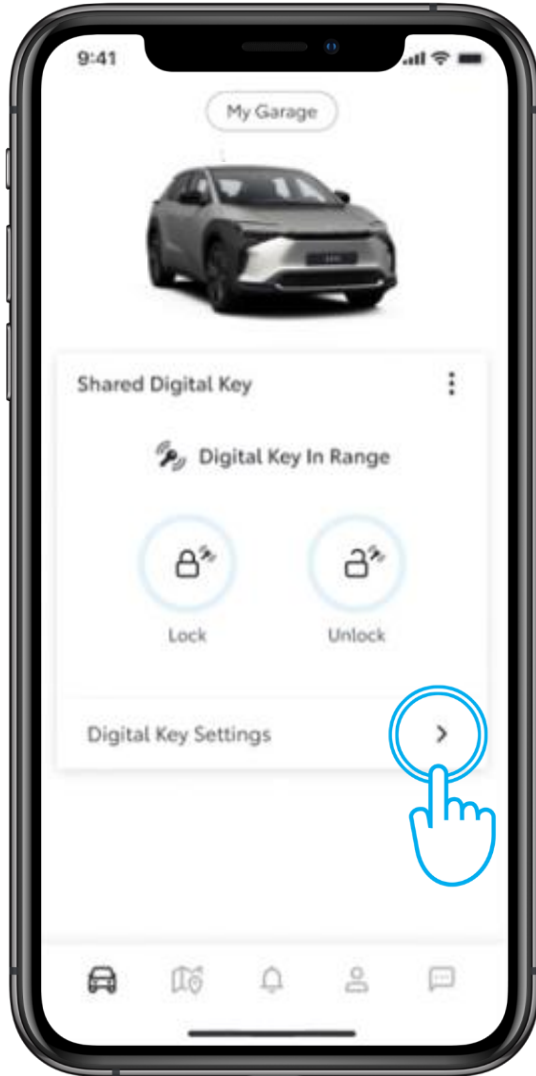

STEP 9

While using the app, blue rings will indicate when Digital Key access is in range.

To manage or remove a shared key, tap "Digital Key Settings".

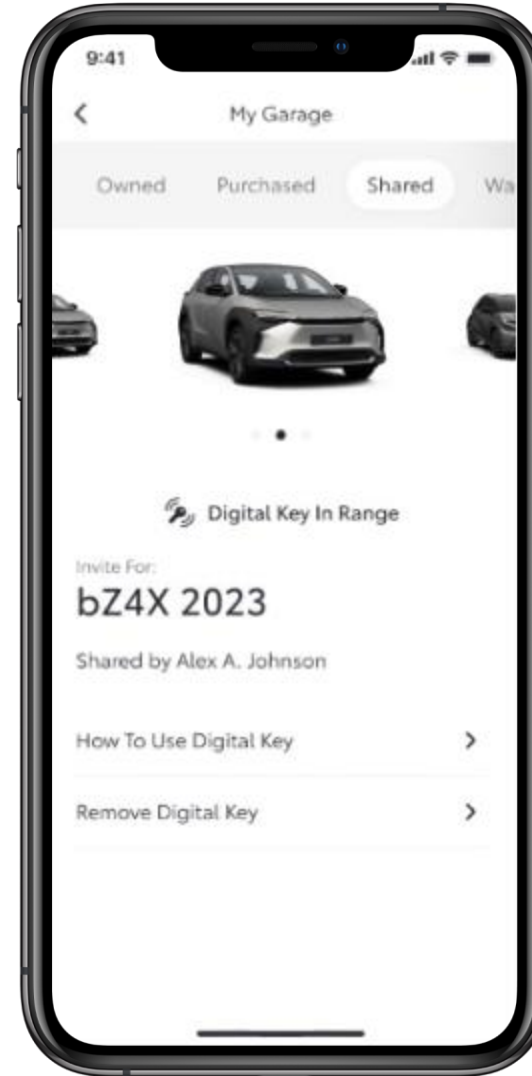

STEP 10

In this section, more information is available on how to use or deactivate Digital Key

Note: The engine start function of the Smart Digital Key will not operate if your vehicle is equipped with an additional immobiliser device, and if the immobiliser key is not present inside the vehicle (same as the physical key).



EVERY FEATURE COUNTS

*Connected Services are continually improving, therefore visuals and app screens in this guide may slightly differ from those seen in your MyToyota App.

